

CONFERENCE CENTRE PARKING - Preston Campus

- 03 9269-8484
- conference@melbournepolytechnic.edu.au
- Preston Conference Centre (Melbourne Polytechnic) Building U / 67 Cramer St, Preston Vic 3072

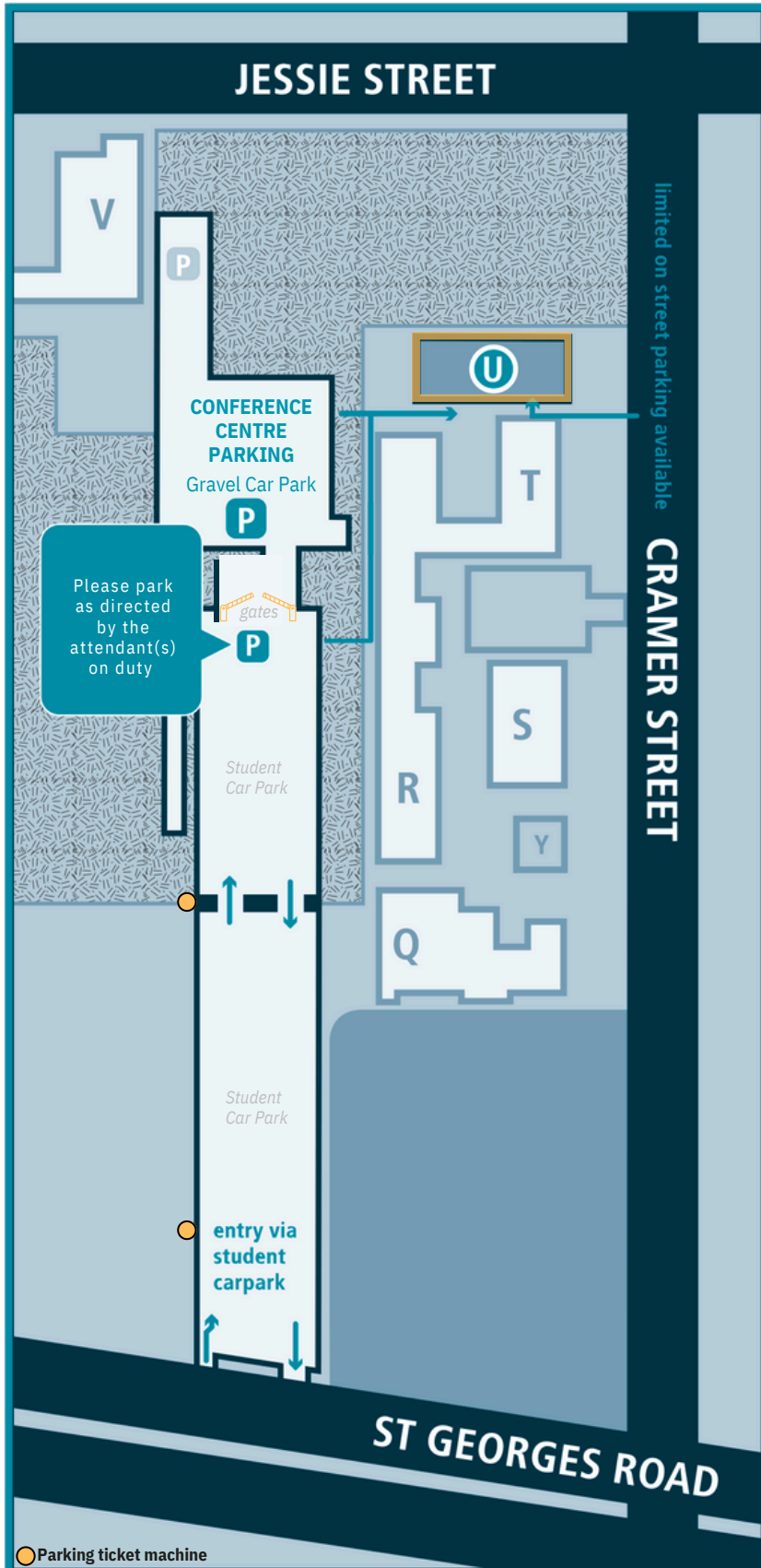

Travel By Car

- Enter the student car park via St Georges Road
- [CLICK HERE](#) for navigation to Student Car Park
- Drive through the top section of the student car park and up on to the gravel carpark through the yellow gates
- Report to the attendant and park as directed
- A permit may be issued if you are allocated to park in the student car park once the gravel area is full
No permit is required when parking on the gravel
- Ensure the permit provided is clearly displayed in the front window of your vehicle
- **Proceed to Building U - Conference Centre**

IMPORTANT NOTICE: OWNER ONUS APPLIES

Ensure to lock your vehicle and DO NOT leave valuable items inside. Melbourne Polytechnic takes no responsibility for damage and/or theft to vehicle or its contents whilst parked on Institute grounds. If a valid permits is not clearly displayed when parking in the student car park, you may receive an infringement notice

Travel By Public Transport

Bus

- 513** Glenroy – Eltham
- 527** Gowrie – Northland
- 552** North East Reservoir – Northcote Plaza
- 553** Preston – West Preston (via Reservoir)
- 903** Smart Bus Mordialloc – Altona

Tram

- 11** Vic Harbour Docklands – West Preston
- 86** Waterfront City Docklands – RMIT Bundoora

Train

- Preston Station** (zones 1 & 2) Mernda Line
- Bell Station** (zone 1) Mernda Line

Please visit

<https://www.ptv.vic.gov.au/journey>
for up to date transport information

Please Note: conference centre parking will only be accessible on request at the time of booking. If it has not been requested, the gravel carpark will likely be locked on your event day and attendees will need to either purchase a ticket to park in the student car park or rely on external street parking

Pay for parking in the student car park via the [CelloPark](#) Australia app (download from the [App Store](#) for iPhone or [Google Play](#) for Android devices) **OR** Purchase an eTicket from the machine in the carpark using a credit or debit card – locations noted on above map